

AMERICAN MOTORS PARTS CATALOG

GROUP 6 TRANSMISSION

STANDARD TRANSMISSION parts may be found beginning on page 119.

OVERDRIVE parts may be found beginning on page 127

AUTOMATIC TRANSMISSION parts may be found in group 16.

DESCRIPTION	GROUP AND FIGURE NO.	GROUP NO.
-------------	----------------------	-----------

GROUP 6.001 STANDARD

BEARING, Transmission Front Ball	6-1, 6-2	6.040
BEARING, Transmission Rear Ball	6-1, 6-2	6.052
BUSHING, Transmission Clutch Shaft	6.064
CAP, Transmission Front Bearing	6-1, 6-2	6.017
CAP, Transmission Rear Bearing	6-1	6.028
CASE, Transmission	6-1, 6-2	6.005
CLUTCH, Transmission Synchronizer	6-1, 6-2	6.080
COUNTERSHAFT, Transmission	6-1, 6-2	6.159
COVER, Transmission Case	6-1, 6-2, 6-3	6.009
FORK, Transmission Shifter	6-1, 6-2, 6-3	6.198
GASKET, Transmission Case Cover	6-1, 6-2	6.009
GASKET, Transmission Rear Bearing Cap	6-1	6.028
GASKET SET, Transmission	6.002
GEAR, Speedometer Drive	Refer Page 117	6.240
GEAR, Transmission Countershaft	6-1, 6-2	6.164
GEAR, Transmission Low and Reverse	6-1, 6-2	6.144
GEAR, Transmission Reverse Idler	6-1, 6-2	6.170
GEAR, Transmission Second Speed	6-1, 6-2	6.120
PIN, Transmission Shifter Fork Sleeve Taper Lock	6-1	6.192
PLATE, Transmission Countershaft Lock	6-1	6.172
PLATE, Transmission Reverse Idler Shaft Lock	6-1	6.172
PLATE, Transmission Synchronizer Clutch Shift	6.100
POPPET, Transmission Speed Finder	6-1, 6-3	6.215
RING, Transmission Front Ball Bearing Lock	6-1, 6-2	6.048
RING, Transmission Front Ball Bearing Snap	6-1, 6-2	6.044
RING, Transmission Rear Ball Bearing Lock	6-1, 6-2	6.056
RING, Transmission Spline Shaft Snap	6-1, 6-2	6.069
RING, Transmission Synchronizer Clutch Friction	6-1	6.090
ROLLER, Transmission Countershaft Gear Bearing	6-1, 6-2	6.167
ROLLER, Transmission Spline Shaft Pilot Bearing	6-1	6.076
SEAL, Transmission Front Bearing Cap Oil	6.021
SEAL, Transmission Rear Bearing Cap Oil	6-1	6.032
SEAL, Transmission Shifter Fork Shaft	6-3	6.194
SHAFT, Transmission Clutch	6-1, 6-2	6.060
SHAFT, Transmission Idler Gear	6-1, 6-2	6.168
SHAFT, Transmission Shifter Fork	6-1, 6-2, 6-3	6.190
SHAFT, Transmission Spline	6-1, 6-2	6.068
SHIM, Transmission Front Bearing Cap	6.024
SLEEVE, Transmission Speed Finder	6-1, 6-3	6.215
SPRING, Transmission Speed Finder	6-1, 6-3	6.215
TRANSMISSION	6-1, 6-2	6.001
WASHER, Transmission Countershaft Gear Thrust	6-1, 6-2	6.166

GROUP 6.250 OVERDRIVE

ADAPTER, Overdrive Housing	6-2, 6-4, 6-5, 6-6	6.265
ADAPTER, Overdrive Rear Oil Seal	6-5	6.286

AMERICAN MOTORS PARTS CATALOG

DESCRIPTION	GROUP AND FIGURE NO.	GROUP NO.
BEARING, Overdrive Front Ball	6-4, 6-5, 6-6	6.275
BEARING, Overdrive Rear Ball	6-2, 6-4, 6-5, 6-6	6.282
BRACKET, Overdrive Control Shaft to Dash	6.357
BRACKET, Overdrive Kickdown Switch	6.370
BUTTON, Overdrive Control	6.352
CAM, Overdrive Free Wheeling	6-4, 6-5, 6-6	6.330
CASE, Overdrive	6-2, 6-4, 6-5, 6-6	6.260
CLAMP, Overdrive Control Cable Lower	6.358
CONTROL, Overdrive	6.350
GASKET, Overdrive Housing Adapter	6-2	6.270
GEAR, Governor Overdrive	6-4, 6-5, 6-6	6.329
GEAR, Overdrive Ring	6-4, 6-5, 6-6	6.307
GEAR, Overdrive Sun	6-4, 6-5, 6-6	6.299
GEAR, Speedometer Drive	Refer Page 117	6.240
GOVERNOR, Overdrive	6-4, 6-5, 6-6	6.329
HUB, Overdrive Sun Gear	6-4, 6-5, 6-6	6.301
OVERDRIVE	6-4, 6-5, 6-6	6.250
PAWL, Overdrive Sun Gear Locking	6-4, 6-5, 6-6	6.305
PINION, Overdrive	6-4, 6-5, 6-6	6.309
PLATE, Sun Gear Balk Cover	6-4, 6-5, 6-6	6.302
RAIL ASSEMBLY, Overdrive Shift	6-4, 6-5, 6-6	6.295
RELAY, Overdrive Kickdown	6.365
RING, Gear Retaining	6-4, 6-5	6.329
RING, Overdrive Free Wheeling Cam	6-6	6.330
RING, Overdrive Front Ball Bearing Snap	6-4, 6-5, 6-6	6.278
RING, Overdrive Main Shaft Snap	6-4, 6-5	6.336
RING, Overdrive Rear Ball Bearing Snap	6-4, 6-5, 6-6	6.284
RING, Overdrive Ring Gear Snap	6-5	6.307
RING, Overdrive Sun Gear Balk	6-4, 6-5, 6-6	6.302
ROLLER, Overdrive Free Wheeling	6-6	6.332
SEAL, Overdrive Rear Oil	6-4, 6-5	6.286
SHAFT, Overdrive Main	6-4, 6-5, 6-6	6.336
SHAFT, Overdrive Spline	6-4, 6-5, 6-6	6.255
SHAFT ASSEMBLY, Overdrive Control	6-4, 6-5, 6-6	6.338
SOLENOID, Overdrive	6-4, 6-5, 6-6	6.328
SWITCH, Overdrive Kickdown	6.367
TRUNNION, Overdrive Control	6.363

AMERICAN MOTORS PARTS CATALOG

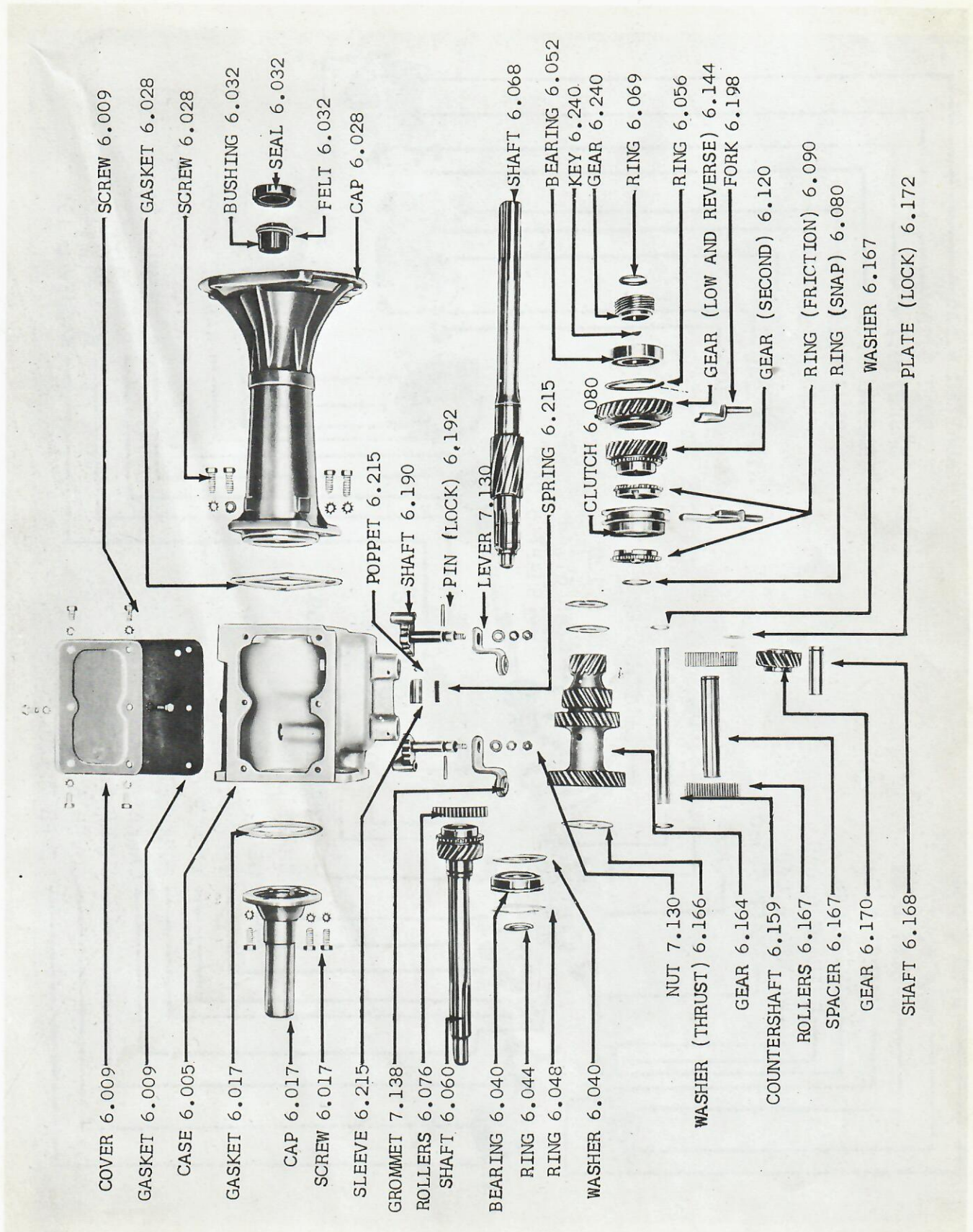

COVER 6.009

GASKET 6.009

CASE 6.005

GASKET 6.017

CAP 6.017

SCREW 6.017

SLEEVE 6.215

GROMMET 7.138

ROLLERS 6.076

SHAFT 6.060

BEARING 6.040

RING 6.044

RING 6.048

WASHER 6.040

NUT 7.130

WASHER (THRUST) 6.166

GEAR 6.164

COUNTERSHAFT 6.159

ROLLERS 6.167

SPACER 6.167

GEAR 6.170

SHAFT 6.168

SCREW 6.009

GASKET 6.028

SCREW 6.028

BUSHING 6.032

SEAL 6.032

FELT 6.032

CAP 6.028

POPPET 6.215

SHAFT 6.190

PIN (LOCK) 6.192

LEVER 7.130

SHAFT 6.068

SPRING 6.215

BEARING 6.052

KEY 6.240

GEAR 6.240

RING 6.069

RING 6.056

GEAR (LOW AND REVERSE) 6.144

FORK 6.198

GEAR (SECOND) 6.120

RING (FRICTION) 6.090

RING (SNAP) 6.080

WASHER 6.167

PLATE (LOCK) 6.172

GROUP 6 - FIG. 1 - TRANSMISSION 01-10-20 (WST)

AMERICAN MOTORS PARTS CATALOG

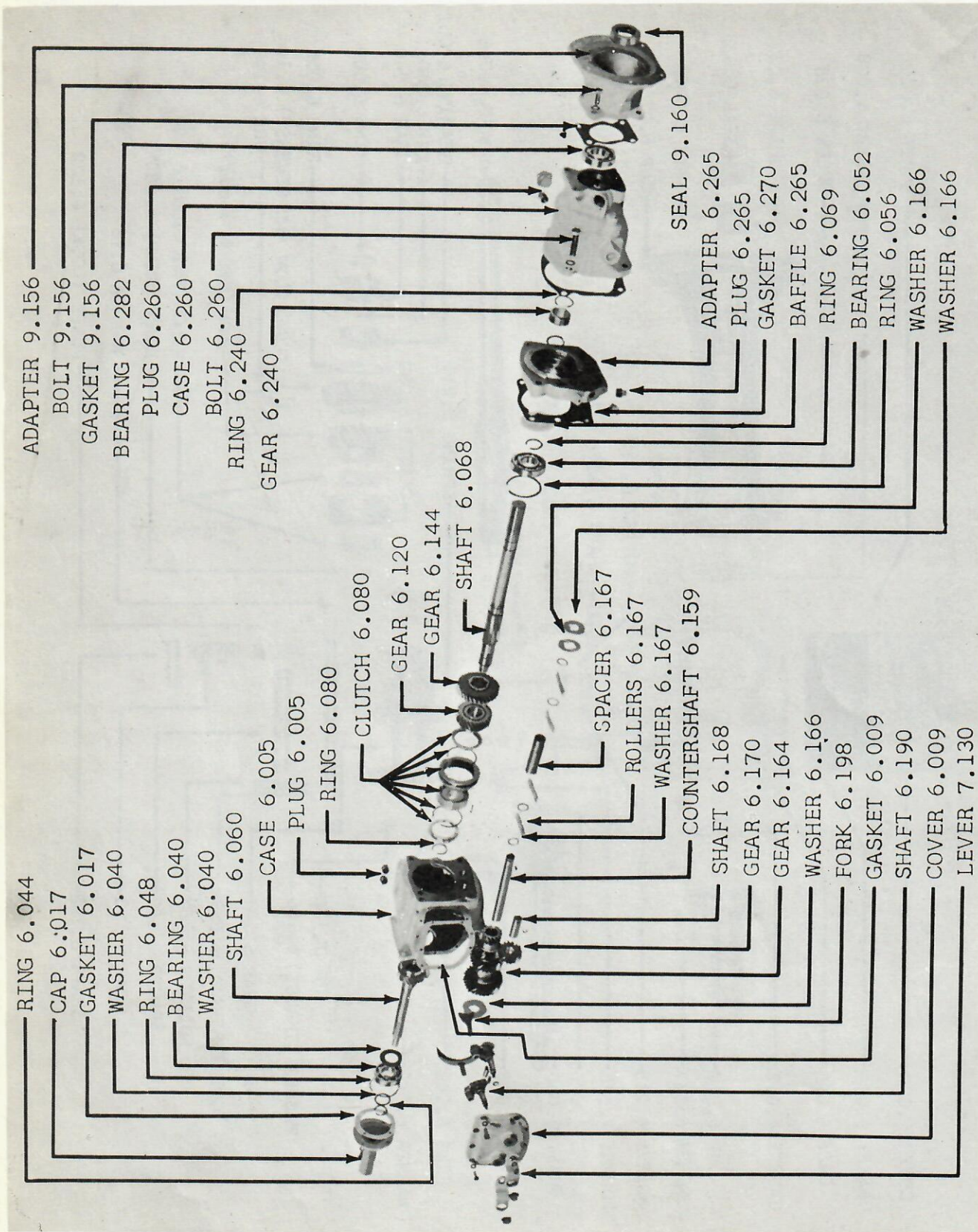

ADAPTER 9.156
BOLT 9.156
GASKET 9.156
BEARING 6.282
PLUG 6.260
CASE 6.260
BOLT 6.260
RING 6.240
GEAR 6.240

RING 6.044
CAP 6.017
GASKET 6.017
WASHER 6.040
RING 6.048
BEARING 6.040
WASHER 6.040
SHAFT 6.060
CASE 6.005
PLUG 6.005
RING 6.080
CLUTCH 6.080
GEAR 6.120
GEAR 6.144
SHAFT 6.068

CLUTCH 6.080
GEAR 6.120
GEAR 6.144
SHAFT 6.068
SPACER 6.167
ROLLERS 6.167
WASHER 6.167
COUNTERSHAFT 6.159
SHAFT 6.168
GEAR 6.170
GEAR 6.164
WASHER 6.166
FORK 6.198
GASKET 6.009
SHAFT 6.190
COVER 6.009
LEVER 7.130

SEAL 9.160
ADAPTER 6.265
PLUG 6.265
GASKET 6.270
BAFFLE 6.265
RING 6.069
BEARING 6.052
RING 6.056
WASHER 6.166
WASHER 6.166

GROUP 6 - FIG. 2 - TRANSMISSION 80 (WST)

AMERICAN MOTORS PARTS CATALOG

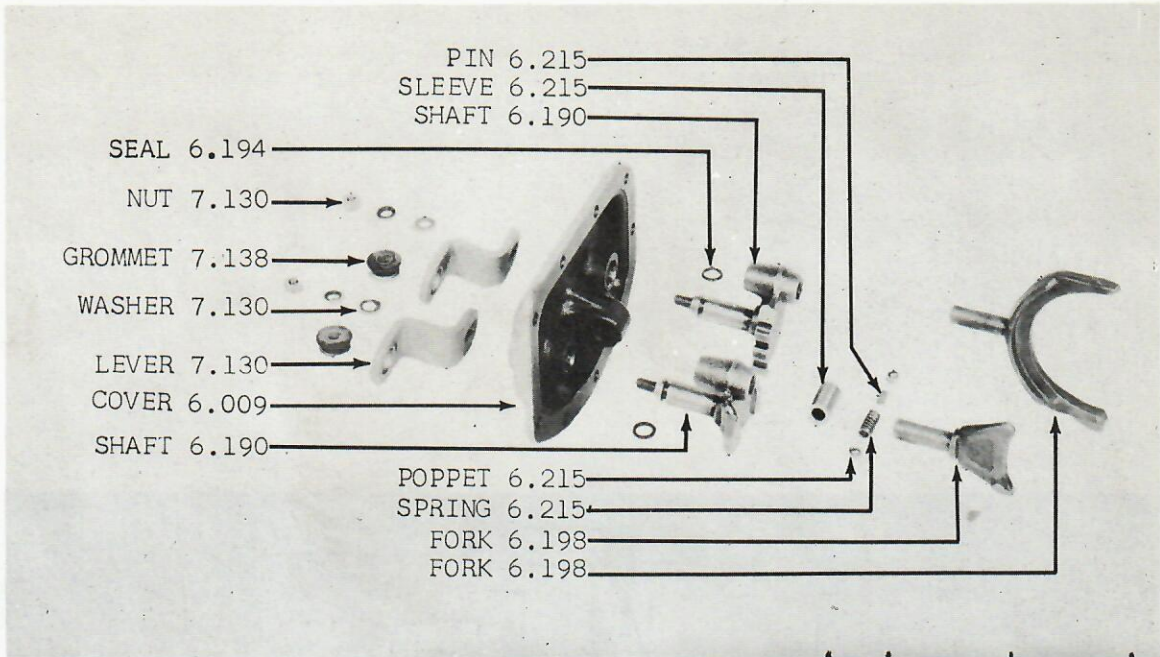

GROUP 6 - FIG. 3 - TRANSMISSION SHIFTING FORK ASSEMBLY 80 (WST)(WOD)

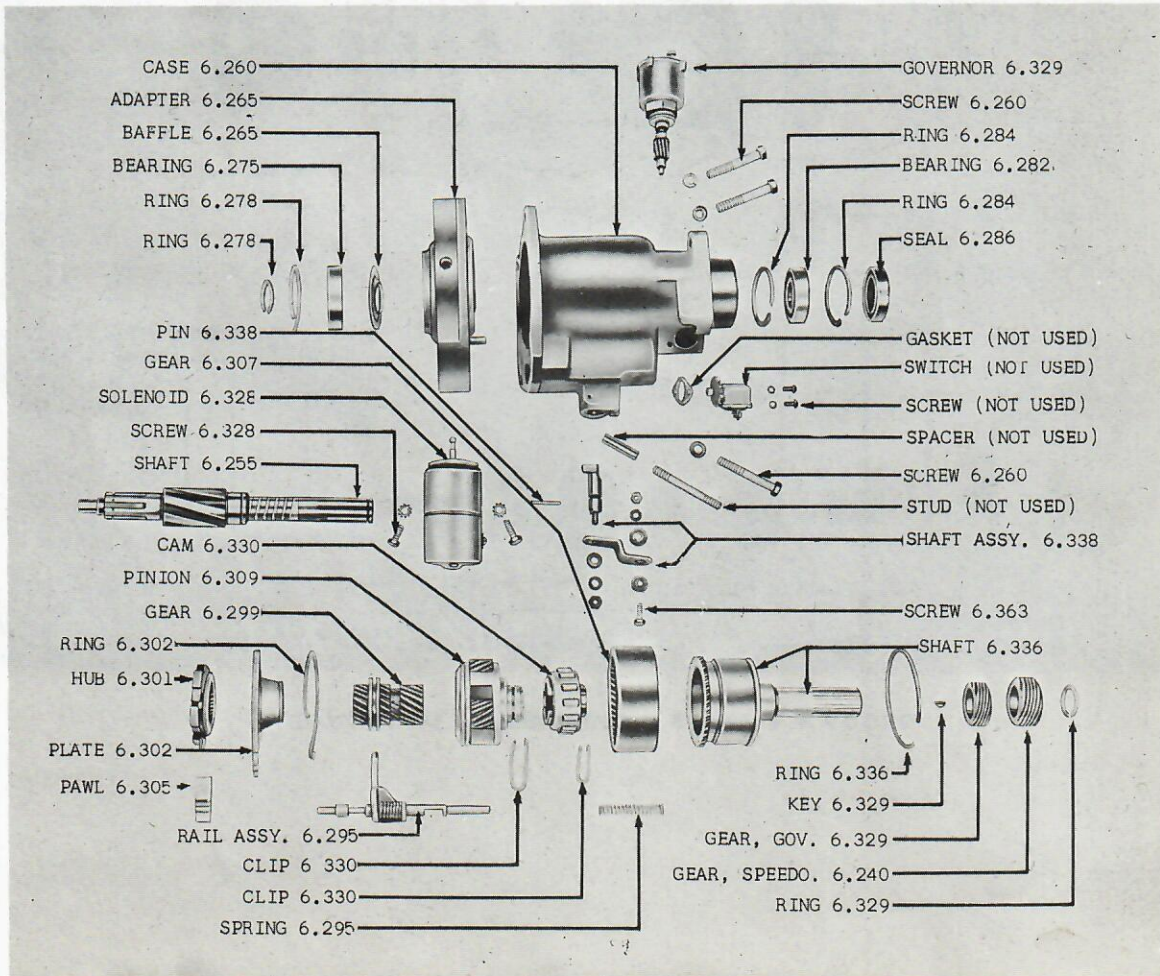

GROUP 6 - FIG. 4 - OVERDRIVE 01 (WOD)

AMERICAN MOTORS PARTS CATALOG

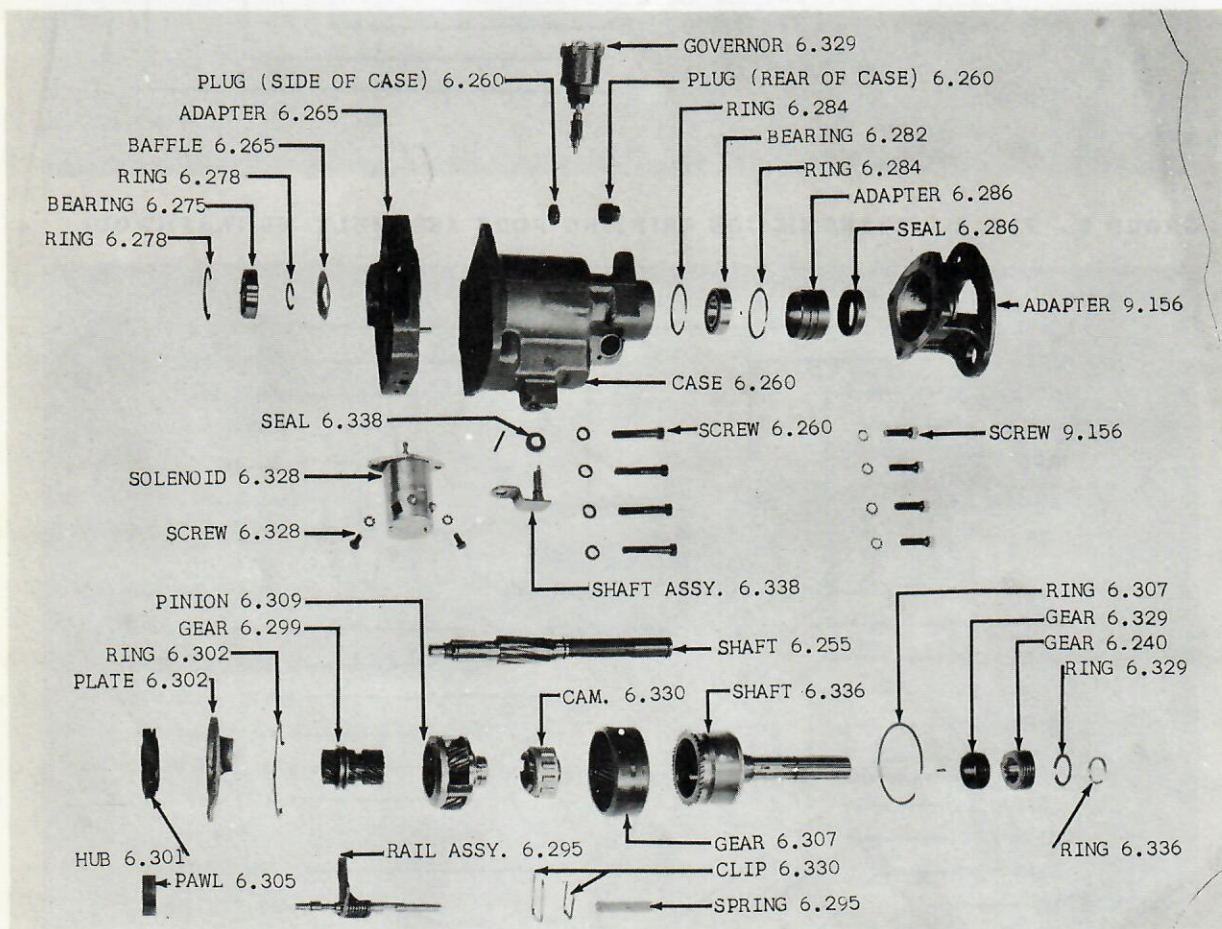

GROUP 6 - FIG. 5 - OVERDRIVE 10-20 (WOD)

AMERICAN MOTORS PARTS CATALOG

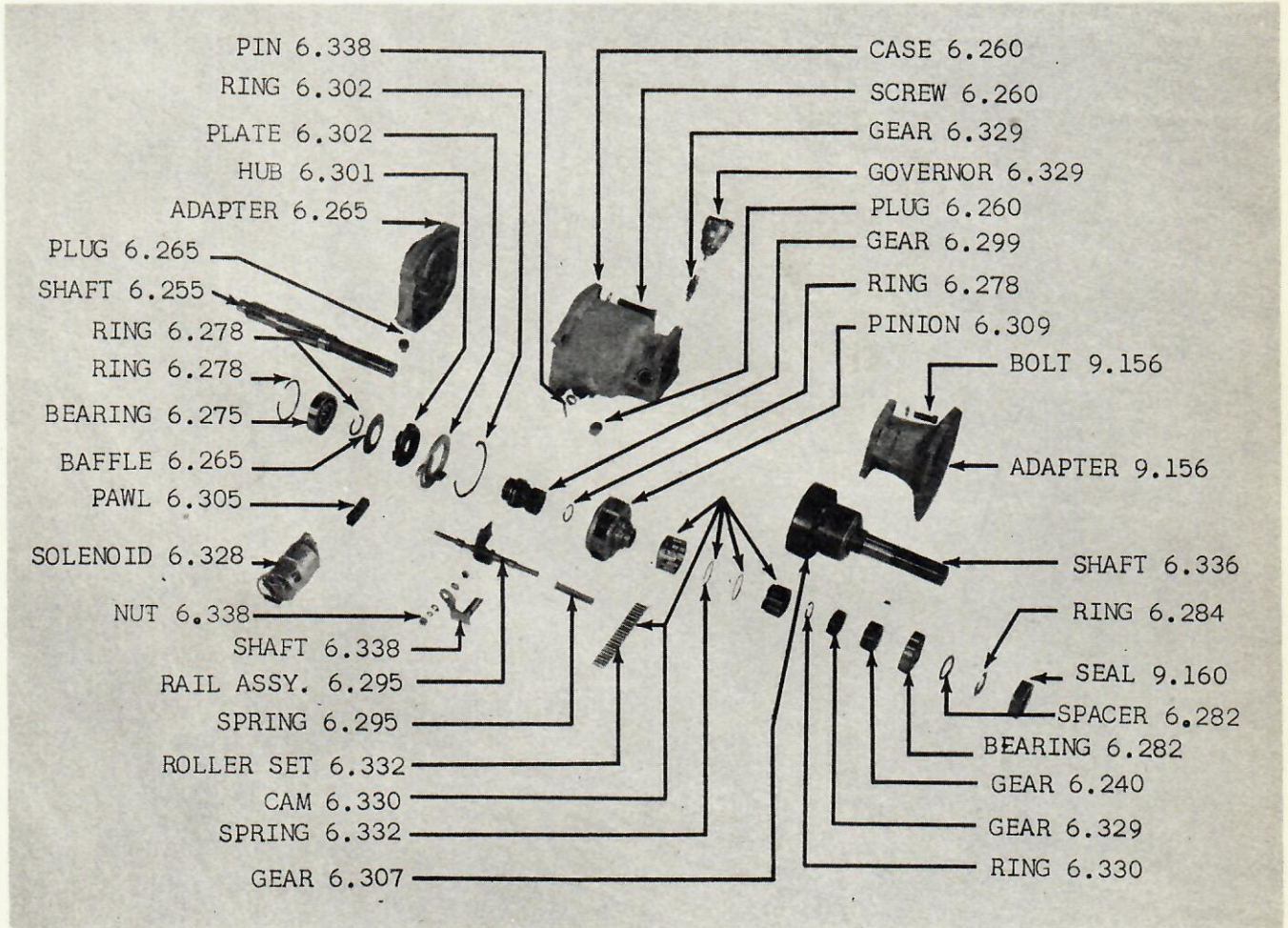

GROUP 6 - FIG. 6 - OVERDRIVE 80 (WOD)

SPEEDOMETER DRIVE GEARS

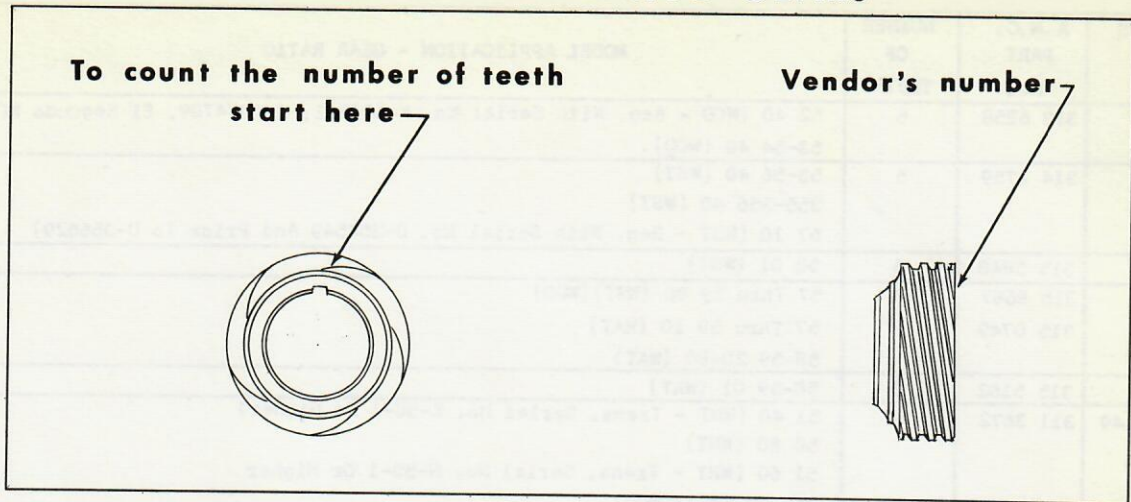

NOTE: This chart does not include Hudson Drive Gears Prior to 1955 models.

(Refer Group 3.000 For Driven Gear Chart)

VENDOR'S PART NO.	A.M.C. PART NO.	NUMBER OF TEETH	MODEL APPLICATION - GEAR RATIO
447011	310 5429	5	46 60 (WOD - 9/40)(Manual Controlled Type Overdrive) 46 60 (WOD - 10/41)(Manual Controlled Type Overdrive)
447012	310 5462	5	46 Thru 48 60 (LOD)
447069	312 1138	5	46 Thru 48 40 (LOD - 8/35) 46 Thru 50 40 (LOD - 9/37)
447125	312 4217	5	47-48 40 (LOD - 8/39) 52 Thru 54 40 (WST) 53 10 (WST - Beg. With Serial No. D-150580) 54 06-14-16-17-21-24-27 (WST - Prior To Serial No. D-172751 And DKD-3001) 54 15-25-28 (WST Prior To Serial No. D-172945)
447130	311 2156	5	46 Thru 51 40 (WOD) 52 40 (WOD - Prior To Serial No. K-554841, 4KD-4709, El Segundo KC-42074) 55-56 40 (WOD) 56 50 (WOD) 46 60 (WOD)(Governor Controlled Type Overdrive) 47 Thru 56 60 (WOD) 355-356 40-60 (WOD) 356 50 (WOD) 50 Thru 58 10 (WOD) 58 01 (WOD) 57-58 20 (WOD)
447152	311 3035	5	49 Thru 56 60 (WST) 56 50 (WST) 355-356 60 (WST) 356 50 (WST) 57 Thru 59 20 (WST)
447157	312 6561	5	49 Thru 51 40 (LOD - 8/35) 49 Thru 51 40 (LOD - 8/39)
447181	311 3830	5	50 10
447198	311 4550	6	50 Thru 52 10 (WST) 53 10 (WST - Prior To Serial No. D-150580) 54 06-14-16-17-21-24-27 (WST - Beg. With Serial No. D-172751 And DKD-3001) 54 15-25-28 (WST - Beg. With Serial No. D-172945) 55 10 (WST) 58 01 (WST - 9/34)

VENDOR'S PART NO.	A.M.C. PART NO.	NUMBER OF TEETH	MODEL APPLICATION - GEAR RATIO
447256	313 6258	6	52 40 (WOD - Beg. With Serial No. K-554841, 4 KD-4709, El Segundo KC-42074) 53-54 40 (WOD)
447258	314 2759	5	55-56 40 (WST) 355-356 40 (WST) 57 10 (WST - Beg. With Serial No. D-354549 And Prior To D-356529)
447404	315 5848	6	58 01 (WST)
447439	315 8687	7	57 Thru 59 80 (WST)(WOD)
3B-169	315 0749	8	57 Thru 59 10 (WAT) 58-59 20-80 (WAT)
5X-169	315 5162	8	58-59 01 (WAT)
7T-1315449	311 3672	8	51 40 (WHT - Trans. Serial No. E-50-1 Or Higher) 50 60 (WHT) 51 60 (WHT - Trans. Serial No. N-50-1 Or Higher) 357 80 (WST)(WOD) 57 30 (WST)(WOD)
R-11-169F	315 0719	5	57 Thru 59 80 (WST)(WOD)
T-90G-169B	315 6635	5	59 10 (WST-Heavy Duty)
T-96-169P	314 6791	5	56 10 (WST) 57 10 (WST - Prior To Serial No. D-354549 And Beg. With D-356529) 58-59 10 (WST)
---	811 1845	5	540 - 560
---	811 0469	8	540
---	811 2354	9	560
---	645 0308	8	(NYLON) 55-56 80 (WUT) (NYLON) 355-356 80 (WUT)

AMERICAN MOTORS PARTS CATALOG

6.005

DESCRIPTION	YEAR AND MODEL	PER CAR PART NO.
-------------	----------------	------------------

GROUP 6 STANDARD & OVERDRIVE TRANSMISSION

6.001 TRANSMISSION

TRANSMISSION (Less Shift Levers).....	59 10 (WST).....	1 320 1230
	59 10 (WST-Heavy Duty)(Note 6.001-1).....	1 320 1273
	59 20 (WST).....	1 320 1275
	59 80 (WST).....	1 320 1277
	59 01 (WOD).....	1 320 1280
	59 10 (WOD).....	1 320 1274
	59 20 (WOD).....	1 320 1276
(13-43 Ratio)..	59 01 (WST).....	1 320 1279
(9-34 Ratio)...	59 01 (WST).....	1 320 1223
(10-41 Ratio)..	59 80 (WOD).....	1 320 1278
(11-39 Ratio)..	59 80 (WOD).....	1 320 1462

6.002 GASKET SET, Transmission

GASKET SET (Incl. 1-3113823, 1-3142756, 1-3108335, 1-3114532, 1-3111263 And 1-3123649).....	59 01 (WST)(WOD).....	1 311 3825
(Incl. 1-3111236, 1-3108335, 1-3114532, 1-3123649,1-3126373, 1-3121137, 1-3124535, 1-3111263, 1-3121595, 1-3113823, 1-3142756 And 2-3130590).....	59 10 (WST)(WOD).....	1 311 3412
(Incl. 1-3142699, 2-91174, 1-91175, 1-3123649, 1-3113005, 1-3111263, 1-3121595 And 1-3123673).....	59 10 (WST-Heavy Duty)(Note 6.001-1): 59 20 (WST)(WOD).....	1 311 8938
(Incl. 1-3150618, 2-3150649, 1-3150650, 1-3150671, 1-3150672 And 1-3150676).....	59 80 (WST)(WOD).....	1 320 0335

6.005 CASE, Transmission

CASE.....	59 01-10 (WST).....	1 311 3826
	59 10 (WST-Heavy Duty)(Note 6.001-1): 59 20 (WST).....	1 311 2967
	59 80 (WST)(WOD).....	1 315 1676
	59 01-10 (WOD).....	1 311 4529
	59 20 (WOD).....	1 311 2968
PLUG, Drain And Filler.....	59 01-10-20-80 (WST)(WOD).....	2 G103880
Expansion.....	59 01-10-20 (WST)(WOD).....	1 G105602
Magnetic Drain.....	59 01-10-20-80 (WST)(WOD)(Special Equipment).	1 315 5923
BREATHER.....	59 80 (WST)(WOD).....	1 315 0594

NOTE 6.001-1: 59 10 (WST) Cars having a production installed Heavy Duty Package may be identified in the following way:
The Trunnion at the Transmission End of the Torque Tube is Welded instead of Threaded to the Torque Tube.

AMERICAN MOTORS PARTS CATALOG

STANDARD TRANSMISSION

6.009 COVER, Transmission Case

COVER.....	59 01-10 (WST)(WOD).....	1	311 3827
	59 10 (WST-Heavy Duty)(Note 6.001-1):		
	59 20 (WST)(WOD).....	1	314 2698
	59 80 (WST)(WOD).....	1	315 0607
GASKET.....	59 01-10 (WST)(WOD).....	1	311 3823
	59 10 (WST-Heavy Duty)(Note 6.001-1):		
	59 20 (WST)(WOD).....	1	314 2699
	59 80 (WST)(WOD).....	1	315 0618
SCREW.....	59 01-10 (WST)(WOD).....	4	G180075
	59 10 (WST-Heavy Duty)(Note 6.001-1):		
	59 20 (WST)(WOD).....	6	G180075
	59 80 (WST)(WOD).....	9	G179817
WASHER (Lock).....	59 01-10 (WST)(WOD).....	4	G114605
	59 10 (WST-Heavy Duty)(Note 6.001-1):		
	59 20 (WST)(WOD).....	6	G114605
	59 80 (WST)(WOD).....	1	G114605
	59 80 (WST)(WOD).....	8	G120214

6.017 CAP, Transmission Front Bearing

CAP.....	59 01-10 (WST)(WOD).....	1	310 8334
	59 10 (WST-Heavy Duty)(Note 6.001-1):		
	59 20 (WST)(WOD).....	1	314 2753
	59 80 (WST)(WOD).....	1	315 0648
GASKET.....	59 01-10 (WST)(WOD).....	1	310 8335
(.010).....	59 80 (WST)(WOD).....	AR	315 0649
(.015).....	59 80 (WST)(WOD).....	AR	315 0650
SCREW.....	59 01-10-20 (WST)(WOD).....	3	G179817
	59 80 (WST)(WOD).....	4	G179817
WASHER (Lock).....	59 01-10-20 (WST)(WOD).....	3	G114605
	59 80 (WST)(WOD).....	4	G114605

6.021 SEAL, Transmission Front Bearing Cap Oil

SEAL.....	59 10 (WST-Heavy Duty)(Note 6.001-1):		
	59 20 (WST)(WOD).....	1	311 3029

6.024 SHIM, Transmission Front Bearing Cap

SHIM (.010).....	59 10 (WST-Heavy Duty)(Note 6.001-1):		
	59 20 (WST)(WOD).....	AR	91 174
	59 80 (WST)(WOD).....	AR	315 0649
(.015).....	59 10 (WST-Heavy Duty)(Note 6.001-1):		
	59 20 (WST)(WOD).....	AR	91 175
	59 80 (WST)(WOD).....	AR	315 0650

6.028 CAP - GASKET, Transmission Rear Bearing

CAP.....	59 01 (WST).....	1	311 3829
	59 10 (WST).....	1	314 5082
	59 10 (WST-Heavy Duty)(Note 6.001-1):		
	59 20 (WST).....	1	313 2500

STANDARD TRANSMISSION

GASKET.....	59 80 (WST)(WOD).....	1	315 0675
	59 01-10 (WST).....	1	314 2756
	59 10 (WST-Heavy Duty)(Note 6.001-1):		
	59 20 (WST).....	1	311 3242
SCREW.....	59 80 (WST)(WOD).....	1	315 0676
	59 01 (WST).....	1	G179868
	59 01-10 (WST).....	3	G179857
	59 10 (WST).....	1	G179863
	59 10 (WST-Heavy Duty)(Note 6.001-1):		
	59 20 (WST).....	1	G179839
	59 10 (WST-Heavy Duty)(Note 6.001-1):		
	59 20 (WST).....	3	G179840
WASHER (Lock).....	59 80 (WST)(WOD).....	4	G179860
	59 01-10 (WST).....	3	G114607
	59 10 (WST-Heavy Duty)(Note 6.001-1):		
	59 20 (WST).....	3	G114606
	59 80 (WST)(WOD).....	4	G114607
(Plain).....	59 01-10 (WST).....	1	314 2758
	59 10 (WST-Heavy Duty)(Note 6.001-1).....	1	314 2761
 6.032 SEAL, Transmission Rear Bearing Cap Oil			
SEAL.....	59 01 (WST)(WOD).....	1	311 3831
	59 10-20 (WST)(WOD).....	1	310 5459
	59 80 (WST)(WOD).....	1	315 0677
BUSHING, Oilite.....	59 10 (WST-Heavy Duty)(Note 6.001-1):		
	59 20 (WST).....	1	312 6502
FELT, Bushing.....	59 10 (WST-Heavy Duty)(Note 6.001-1):		
	59 20 (WST).....	1	312 6516
 6.040 BEARING, Transmission Front Ball			
BEARING.....	59 01-10-20 (WST)(WOD).....	1	91 951
	59 10 (WST-Heavy Duty)(Note 6.001-1).....	1	315 6627
	59 80 (WST)(WOD).....	1	315 0654
WASHER.....	59 80 (WST)(WOD).....	1	315 0656
Oil Retaining.....	59 01-10-20 (WST)(WOD).....	1	311 3033
	59 80 (WST)(WOD).....	1	315 0662
 6.044 RING, Transmission Front Ball Bearing Snap			
RING (.087).....	59 01-10 (WST)(WOD).....	1	311 3833
	59 10 (WST-Heavy Duty)(Note 6.001-1):		
	59 20 (WST)(WOD).....	1	310 4169
	59 80 (WST)(WOD).....	1	315 0622
(.090).....	59 10 (WST-Heavy Duty)(Note 6.001-1):		
	59 20 (WST)(WOD).....	1	310 4170
	59 80 (WST)(WOD).....	1	315 0657
(.092).....	59 01-10 (WST)(WOD).....	1	310 8339
(.093).....	59 10 (WST-Heavy Duty)(Note 6.001-1):		
	59 20 (WST)(WOD).....	1	310 4171
	59 80 (WST)(WOD).....	1	315 0658
(.095).....	59 01-10 (WST)(WOD).....	1	310 8340

STANDARD TRANSMISSION

(.096).....	59 10 (WST-Heavy Duty)(Note 6.001-1):		
	59 20 (WST)(WOD).....	1	310 4172
	59 80 (WST)(WOD).....	1	315 0659
(.098).....	59 01-10 (WST)(WOD).....	1	310 8341
(.099).....	59 80 (WST)(WOD).....	1	315 0660
(.100).....	59 01-10 (WST)(WOD).....	1	314 2752
(.101).....	59 10 (WST-Heavy Duty)(Note 6.001-1):		
	59 20 (WST)(WOD).....	1	314 2755
(.102).....	59 80 (WST)(WOD).....	1	315 0661
 6.048 RING, Transmission Front Ball Bearing Lock			
RING.....	59 10 (WST-Heavy Duty)(Note 6.001-1):		
	59 20 (WST)(WOD).....	1	91 182
	59 80 (WST)(WOD).....	1	315 0655
(.073-.075).....	59 01-10 (WST)(WOD).....	1	311 3832
(.076-.078).....	59 01-10 (WST)(WOD).....	1	310 8338
 6.052 BEARING, Transmission Rear Ball			
BEARING.....	59 01-10 (WST).....	1	310 8320
	59 01-10 (WOD).....	1	312 1135
	59 10 (WST-Heavy Duty)(Note 6.001-1).....	1	315 6628
	59 20 (WST)(WOD).....	1	91 951
	59 80 (WST)(WOD).....	1	315 0664
 6.056 RING, Transmission Rear Ball Bearing Lock			
RING (.062).....	59 01 (WOD).....	1	311 6069
(.065).....	59 01 (WOD).....	1	311 6070
(.068).....	59 01 (WOD).....	1	311 6071
(.071).....	59 01 (WOD).....	1	311 6072
(.074).....	59 01-10 (WST).....	1	311 3844
(.087).....	59 10 (WST).....	1	310 8405
	59 10 (WST-Heavy Duty)(Note 6.001-1):		
	59 20 (WST)(WOD).....	1	91 942
(.088).....	59 80 (WST)(WOD).....	1	315 0665
(.090).....	59 10 (WST).....	1	310 8406
	59 10 (WST-Heavy Duty)(Note 6.001-1):		
	59 20 (WST)(WOD).....	1	91 943
(.091).....	59 80 (WST)(WOD).....	1	315 0666
(.093).....	59 10 (WST).....	1	310 8407
	59 10 (WST-Heavy Duty)(Note 6.001-1):		
	59 20 (WST)(WOD).....	1	91 944
(.094).....	59 10 (WOD).....	1	314 3100
	59 80 (WST)(WOD).....	1	315 0667
(.096).....	59 10 (WST).....	1	310 8408
	59 10 (WOD).....	1	314 3101
(.097).....	59 80 (WST)(WOD).....	1	315 0668
(.098).....	59 10 (WOD).....	1	314 3102
(.100).....	59 80 (WST)(WOD).....	1	315 0669
(.103).....	59 10 (WOD).....	1	314 3103

STANDARD TRANSMISSION

6.060 SHAFT, Transmission Clutch

SHAFT.....	59 01-10 (WST)(WOD).....	1	314 2748
	59 10 (WST-Heavy Duty)(Note 6.001-1):		
	59 20 (WST)(WOD).....	1	314 3107
	59 80 (WST)(WOD).....	1	315 0653

6.064 BUSHING, Transmission Clutch Shaft

BUSHING.....	59 01-10 (WST)(WOD).....	1	310 6507
	59 10 (WST-Heavy Duty)(Note 6.001-1):		
	59 20-80 (WST)(WOD).....	1	59 789

6.068 SHAFT, Transmission Spline

SHAFT (Trans. Drive).....	59 01-10 (WST).....	1	311 3849
	59 10 (WST-Heavy Duty)(Note 6.001-1).....	1	315 6632
	59 20 (WST).....	1	311 2985
	59 80 (WST).....	1	315 0634
(Overdrive Spline).....	59 01-10 (WOD).....	1	311 4530
	59 20 (WOD).....	1	311 2986
	59 80 (WOD).....	1	315 0632

6.069 RING, Transmission Spline Shaft Snap

RING (.087).....	59 01-10 (WST)(WOD).....	1	310 8405
	59 10 (WST-Heavy Duty)(Note 6.001-1):		
	59 20 (WST)(WOD).....	1	310 4169
	59 80 (WST)(WOD).....	1	315 0622
(.090).....	59 01-10 (WST)(WOD).....	1	310 8406
	59 10 (WST-Heavy Duty)(Note 6.001-1):		
	59 20 (WST)(WOD).....	1	310 4170
	59 80 (WST)(WOD).....	1	315 0657
(.093).....	59 01-10 (WST)(WOD).....	1	310 8407
	59 10 (WST-Heavy Duty)(Note 6.001-1):		
	59 20 (WST)(WOD).....	1	310 4171
	59 80 (WST)(WOD).....	1	315 0658
(.096).....	59 01-10 (WST)(WOD).....	1	310 8408
	59 10 (WST-Heavy Duty)(Note 6.001-1):		
	59 20 (WST)(WOD).....	1	310 4172
	59 80 (WST)(WOD).....	1	315 0659
(.099).....	59 80 (WST)(WOD).....	1	315 0660
(.101).....	59 10 (WST-Heavy Duty)(Note 6.001-1):		
	59 20 (WST)(WOD).....	1	314 2755
	59 80 (WST)(WOD).....	1	315 0661

6.076 ROLLER, Transmission Spline Shaft Pilot Bearing

ROLLER.....	59 01-10 (WST)(WOD).....	13	310 8343
	59 10 (WST-Heavy Duty)(Note 6.001-1):		
	59 20 (WST)(WOD).....	14	91 947
	59 80 (WST)(WOD).....	14	315 0619
SPACER.....	59 80 (WST)(WOD).....	1	315 0620

STANDARD TRANSMISSION

6.080 CLUTCH, Transmission Synchronizer

CLUTCH.....	59 01-10 (WST)(WOD).....	1	312 7226
	59 10 (WST-Heavy Duty)(Note 6.001-1):		
	59 20 (WST)(WOD).....	1	311 3036
	59 80 (WST)(WOD).....	1	315 0631
RING, Snap.....	59 01-10 (WST)(WOD).....	1	310 8318
	59 10 (WST-Heavy Duty)(Note 6.001-1):		
	59 20 (WST)(WOD).....	1	310 4169
	59 80 (WST)(WOD).....	1	315 0622

6.090 RING, Transmission Synchronizer Clutch Friction

RING (Incl. 2).....	59 01-10 (WST)(WOD).....	1	311 7001
	59 10 (WST-Heavy Duty)(Note 6.001-1):		
	59 20 (WST)(WOD).....	1	311 3247
	59 80 (WST)(WOD).....	1	320 0045

6.100 PLATE, Transmission Synchronizer Clutch Shift

PLATE.....	59 01-10 (WST)(WOD).....	3	311 3847
	59 10 (WST-Heavy Duty)(Note 6.001-1):		
	59 20 (WST)(WOD).....	3	310 8241
	59 80 (WST)(WOD).....	3	315 0628
SPRING, Retaining.....	59 01-10 (WST)(WOD).....	2	310 8317
	59 10 (WST-Heavy Duty)(Note 6.001-1):		
	59 20 (WST)(WOD).....	2	310 8242
	59 80 (WST)(WOD).....	2	315 0627

6.120 GEAR, Transmission Second Speed

GEAR.....	59 01-10 (WST)(WOD).....	1	314 2734
	59 10 (WST-Heavy Duty)(Note 6.001-1):		
	59 20 (WST)(WOD).....	1	314 7623
	59 80 (WST)(WOD).....	1	315 0626

6.144 GEAR, Transmission Low And Reverse

GEAR.....	59 01-10 (WST)(WOD).....	1	314 2737
	59 10 (WST-Heavy Duty)(Note 6.001-1).....	1	315 6634
	59 20 (WST)(WOD).....	1	314 7622
	59 80 (WST)(WOD).....	1	315 0621

6.159 COUNTERSHAFT, Transmission

COUNTERSHAFT.....	59 01-10 (WST)(WOD).....	1	311 3837
	59 10 (WST-Heavy Duty)(Note 6.001-1):		
	59 20 (WST)(WOD).....	1	311 3025
	59 80 (WST)(WOD).....	1	315 0637

6.164 GEAR, Transmission Countershaft

GEAR (Cluster Gear).....	59 01-10 (WST)(WOD).....	1	314 2738
	59 10 (WST-Heavy Duty)(Note 6.001-1).....	1	315 6633
	59 20 (WST)(WOD).....	1	314 7624
	59 80 (WST)(WOD).....	1	315 0644

STANDARD TRANSMISSION

6.166 WASHER, Transmission Countershaft Gear Thrust

WASHER (Front).....	59 01-10 (WST)(WOD).....	1	311 3840
	59 10 (WST-Heavy Duty)(Note 6.001-1).....	1	315 6630
	59 20 (WST)(WOD).....	1	311 2994
	59 80 (WST)(WOD).....	1	315 0641
(Rear)(Less Lip).....	59 01-10 (WST)(WOD).....	1	311 3839
	59 10 (WST-Heavy Duty)(Note 6.001-1):		
	59 20 (WST)(WOD).....	1	311 2995
	59 80 (WST)(WOD).....	1	315 0640
(With Lip).....	59 01-10 (WST)(WOD).....	1	311 3838
	59 10 (WST-Heavy Duty)(Note 6.001-1):		
	59 20 (WST)(WOD).....	1	311 2996
	59 80 (WST)(WOD).....	1	315 0639

6.167 ROLLER, Transmission Countershaft Gear Bearing

ROLLER.....	59 01-10 (WST)(WOD).....	40	311 2997
	59 10 (WST-Heavy Duty)(Note 6.001-1):		
	59 20 (WST)(WOD).....	44	311 2997
	59 80 (WST)(WOD).....	80	315 0638
SPACER.....	59 01-10 (WST)(WOD).....	1	311 3842
	59 10 (WST-Heavy Duty)(Note 6.001-1):		
	59 20 (WST)(WOD).....	1	314 2739
	59 80 (WST)(WOD).....	1	315 0643
WASHER.....	59 01-10 (WST)(WOD).....	2	311 3841
	59 10 (WST-Heavy Duty)(Note 6.001-1):		
	59 20 (WST)(WOD).....	4	311 2993
	59 80 (WST)(WOD).....	4	315 0642

6.168 SHAFT, Transmission Idler Gear

SHAFT.....	59 01-10 (WST)(WOD).....	1	311 3836
	59 10 (WST-Heavy Duty)(Note 6.001-1):		
	59 20 (WST)(WOD).....	1	311 3026
	59 80 (WST)(WOD).....	1	315 0636

6.170 GEAR, Transmission Reverse Idler

GEAR (Incl. Bushing).....	59 01-10 (WST)(WOD).....	1	311 3835
	59 10 (WST-Heavy Duty)(Note 6.001-1).....	1	315 6669
	59 20 (WST)(WOD).....	1	311 2990
	59 80 (WST)(WOD).....	1	315 0647

6.172 PLATE AND KEY, Transmission Reverse Idler Shaft And Countershaft Lock

PLATE.....	59 01-10 (WST)(WOD).....	1	310 8333
	59 10 (WST-Heavy Duty)(Note 6.001-1):		
	59 20 (WST)(WOD).....	1	311 3027
KEY.....	59 80 (WST)(WOD).....	2	G103905

6.190 SHAFT, Transmission Shifter Fork

SHAFT (Low And Reverse).....	59 01-10 (WST)(WOD).....	1	311 3855
	59 10 (WST-Heavy Duty)(Note 6.001-1):		
	59 20 (WST)(WOD).....	1	311 2973

STANDARD TRANSMISSION

	59 80 (WST)(WOD).....	1	315 0604
(Second And High).....	59 01-10 (WST)(WOD).....	1	311 3856
	59 10 (WST-Heavy Duty)(Note 6.001-1):		
	59 20 (WST)(WOD).....	1	311 2972
	59 80 (WST)(WOD).....	1	315 0606
6.192 PIN, Transmission Shifter Fork Sleeve Taper Lock			
PIN.....	59 01-10-20 (WST)(WOD).....	2	G103565
6.194 SEAL, Transmission Shifter Fork Shaft			
SEAL.....	59 01-10-20 (WST)(WOD).....	2	312 3668
	59 80 (WST)(WOD).....	2	315 0617
6.198 FORK, Transmission Shifter			
FORK (Low And Reverse).....	59 01-10 (WST)(WOD).....	1	311 3850
	59 10 (WST-Heavy Duty)(Note 6.001-1):		
	59 20 (WST)(WOD).....	1	311 2977
	59 80 (WST)(WOD).....	1	315 0610
(Second And High).....	59 01-10 (WST)(WOD).....	1	311 3851
	59 10 (WST-Heavy Duty)(Note 6.001-1):		
	59 20 (WST)(WOD).....	1	311 2976
	59 80 (WST)(WOD).....	1	315 0609
6.215 FINDER, Transmission Speed			
PIN, Interlock.....	59 01-10-20 (WST)(WOD).....	1	311 3852
	59 80 (WST)(WOD).....	1	315 0616
SLEEVE, Interlock (1.008" Long).....	59 80 (WST)(WOD).....	1	315 0614
(1.013" Long).....	59 80 (WST)(WOD).....	1	315 0613
(1.018" Long).....	59 80 (WST)(WOD).....	1	315 0612
(1.023" Long).....	59 80 (WST)(WOD).....	1	315 0615
(1.287" Long).....	59 01-10-20 (WST)(WOD).....	1	311 2982
(1.291" Long).....	59 01-10-20 (WST)(WOD).....	1	311 2981
(1.295" Long).....	59 01-10-20 (WST)(WOD).....	1	311 2980
(1.299" Long).....	59 01-10-20 (WST)(WOD).....	1	311 2979
(1.303" Long).....	59 01-10-20 (WST)(WOD).....	1	311 2983
POPPET, Interlock.....	59 01-10-20 (WST)(WOD).....	2	G169110
	59 80 (WST)(WOD).....	2	G147500
SPRING, Interlock Poppet.....	59 01-10-20 (WST)(WOD).....	1	311 2984
	59 80 (WST)(WOD).....	1	315 0611
6.240 GEAR, Speedometer Drive			
GEAR.....	59 10 (WST).....	1	314 6791
	59 10 (WST-Heavy Duty)(Note 6.001-1).....	1	315 6635
	59 20 (WST).....	1	311 3035
	59 01-10-20 (WOD).....	1	311 2156
(5 Teeth).....	59 80 (WST)(WOD).....	1	315 0719
(7 Teeth).....	59 80 (WST)(WOD).....	1	315 8687
(9/34 Ratio).....	59 01 (WST).....	1	311 4550
(13/43 Ratio).....	59 01 (WST).....	1	315 5848
KEY.....	59 01-10-20-80 (WST)(WOD).....	1	G106749
RING.....	59 80 (WST)(WOD).....	2	315 0622

OVERDRIVE

6.250 OVERDRIVE

OVERDRIVE (Incl. Transmission).....	59 01 (WOD).....	1	320 1280
	59 10 (WOD).....	1	320 1274
	59 20 (WOD).....	1	320 1276
(11-39 Ratio)...	59 80 (WOD).....	1	320 1462
(10-41 Ratio)...	59 80 (WOD).....	1	320 1278

6.255 SHAFT, Overdrive Spline

SHAFT (Transmission Spline Shaft).....	59 01-10 (WOD).....	1	311 4530
	59 20 (WOD).....	1	311 2986
	59 80 (WOD).....	1	315 0632

6.260 CASE, Overdrive

CASE.....	59 01 (WOD).....	1	314 4613
	59 10-20 (WOD).....	1	314 4607
	59 80 (WOD).....	1	315 0680
	59 80 (WST).....	1	315 0673
PLUG (3/8").....	59 01-10-20 (WOD).....	1	G103879
(3/4").....	59 01-10-20 (WOD).....	1	G219301
(1/2").....	59 80 (WST) (WOD).....	2	G103880
Magnetic Drain.....	59 01-10-20 (WOD) (Special Equipment).....	1	315 5924
Taper.....	59 01-10-20-80 (WOD).....	1	314 5192
GASKET, Transmission To Overdrive Adapter.....	59 01-10 (WOD).....	1	311 4532
	59 20 (WOD).....	1	311 3005
SCREW, Transmission To Overdrive	59 01-10-20 (WOD).....	4	G179868
	59 80 (WST) (WOD).....	4	G179892
WASHER (Lock).....	59 01-10-20 (WOD).....	4	G103322
	59 80 (WST) (WOD).....	4	G114608

6.265 ADAPTER, Overdrive Housing

ADAPTER.....	59 01 (WOD).....	1	311 4533
	59 10 (WOD).....	1	314 3098
	59 20 (WOD).....	1	312 3650
	59 80 (WOD).....	1	315 0681
	59 80 (WST).....	1	315 0663
BAFFLE, Oil.....	59 01-10 (WOD).....	1	311 4534
	59 20 (WOD).....	1	312 3651
	59 80 (WST) (WOD).....	1	315 0670

6.270 GASKET, Overdrive Housing Adapter

GASKET.....	59 01-10-20 (WOD).....	1	312 3649
(Front).....	59 80 (WST) (WOD).....	1	315 0671
(Rear).....	59 80 (WST) (WOD).....	1	315 0672

6.275 BEARING, Overdrive Front Ball

BEARING.....	59 01-10 (WOD).....	1	312 1135
	59 20 (WOD).....	1	91 951
	59 80 (WST) (WOD).....	1	315 0664

OVERDRIVE

6.278 RING, Overdrive Front Ball Bearing Snap

RING (.062).....	59 01 (WOD).....	1	311 6069
(.065).....	59 01 (WOD).....	1	311 6070
(.068).....	59 01 (WOD).....	1	311 6071
(.071).....	59 01 (WOD).....	1	311 6072
(Inner)(.086).....	59 80 (WOD).....	1	315 0622
(.087).....	59 10 (WOD).....	1	310 8405
	59 20 (WOD).....	1	310 4169
(.089).....	59 80 (WOD).....	1	315 0657
(.090).....	59 10 (WOD).....	1	310 8406
	59 20 (WOD).....	1	310 4170
(.092).....	59 80 (WOD).....	1	315 0658
(.093).....	59 10 (WOD).....	1	310 8407
	59 20 (WOD).....	1	310 4171
(.095).....	59 80 (WOD).....	1	315 0659
(.096).....	59 10 (WOD).....	1	310 8408
	59 20 (WOD).....	1	310 4172
(Outer)(.087).....	59 20 (WOD).....	1	91 942
(.088).....	59 80 (WOD).....	1	315 0665
(.090).....	59 20 (WOD).....	1	91 943
(.091).....	59 80 (WOD).....	1	315 0666
(.093).....	59 20 (WOD).....	1	91 944
(.094).....	59 10 (WOD).....	1	314 3100
	59 80 (WOD).....	1	315 0667
(.096).....	59 10 (WOD).....	1	314 3101
(.097).....	59 80 (WOD).....	1	315 0668
(.098).....	59 10 (WOD).....	1	314 3102
(.100).....	59 80 (WOD).....	1	315 0669
(.103).....	59 10 (WOD).....	1	314 3103

6.282 BEARING, Overdrive Rear Ball

BEARING.....	59 01-10-20 (WOD).....	1	312 1135
	59 80 (WST)(WOD).....	1	91 951
SPACER.....	59 01-10-20 (WOD).....	1	311 5977
	59 80 (WST)(WOD).....	1	315 0656

6.284 RING, Overdrive Rear Ball Bearing Snap

RING (Inner And Outer)(.062).....	59 01-10-20 (WOD).....	1	310 8331
(Outer)(.065).....	59 01-10-20 (WOD).....	1	310 8336
(.068).....	59 01-10-20 (WOD).....	1	310 8346
(.071).....	59 01-10-20 (WOD).....	1	310 8347
(.086).....	59 80 (WOD).....	1	315 0622
(.089).....	59 80 (WOD).....	1	315 0657
(.092).....	59 80 (WOD).....	1	315 0658
(.095).....	59 80 (WOD).....	1	315 0659
(.099).....	59 80 (WOD).....	1	315 0660
(.102).....	59 80 (WOD).....	1	315 0661

6.286 SEAL, Overdrive Rear Oil

SEAL.....	59 01 (WOD).....	1	311 3831
	59 10-20 (WOD).....	1	310 5459

OVERDRIVE

	59 80 (WST)(WOD).....	1	315 0677
ADAPTER.....	59 01-10-20 (WOD).....	1	312 6342
 6.295 RAIL ASSEMBLY, Overdrive Shift			
RAIL ASSEMBLY.....	59 01-10 (WOD).....	1	314 9958
	59 20 (WOD).....	1	314 9957
	59 80 (WOD).....	1	315 0716
FORK.....	59 01-10-20-80 (WOD).....	1	315 0714
RAIL.....	59 01-10 (WOD).....	1	314 4614
	59 20 (WOD).....	1	314 4609
	59 80 (WOD).....	1	315 0715
WASHER "C".....	59 01-10-20-80 (WOD).....	1	314 2802
CUP, "C" Washer.....	59 01-10-20-80 (WOD).....	1	314 2803
PIN, Guide.....	59 01-10-20-80 (WOD).....	1	312 3666
SPRING, Reverse Lockup.....	59 01-10-20-80 (WOD).....	1	314 2801
Retractor.....	59 01-10-20-80 (WOD).....	1	312 4351
 6.299 GEAR, Overdrive Sun			
GEAR (Incl. Snap Ring).....	59 01-10-20 (WOD).....	1	312 3658
	59 80 (WOD).....	1	315 0689
 6.301 HUB, Overdrive Sun Gear			
HUB (Incl. Balk Ring).....	59 01-10-20 (WOD).....	1	312 3652
	59 80 (WOD).....	1	315 0683
 6.302 RING, Overdrive Sun Gear Balk			
RING.....	59 01-10-20-80 (WOD).....	1	314 2762
Snap (.063).....	59 01-10-20-80 (WOD).....	1	312 3654
(.071).....	59 01-10-20-80 (WOD).....	1	312 3655
(.067).....	59 01-10-20-80 (WOD).....	1	312 3656
PLATE, Cover (Incl. Trough).....	59 01-10-20 (WOD).....	1	312 3653
	59 80 (WOD).....	1	315 0685
 6.305 PAWL, Overdrive Sun Gear Locking			
PAWL.....	59 01-10-20 (WOD).....	1	311 2915
	59 80 (WOD).....	1	315 0684
 6.307 GEAR, Overdrive Ring			
GEAR.....	59 01-10-20 (WOD).....	1	311 3999
	59 80 (WOD).....	1	315 0707
RING, Snap (.055).....	59 80 (WOD).....	1	315 0708
(.057).....	59 80 (WOD).....	1	315 0709
(.059).....	59 80 (WOD).....	1	315 0710
(.062).....	59 01-10-20 (WOD).....	1	312 3664
 6.309 PINION, Overdrive			
PINION (Planetary Gear).....	59 01-10-20 (WOD).....	1	312 3659
	59 80 (WOD).....	1	315 0697

OVERDRIVE

6.328 SOLENOID, Overdrive

SOLENOID.....	59 01-10-20-80 (WOD).....	1 314 6816
CONTACT SET (Upper)(Delco Remy).....	59 01-10-20-80 (WOD).....	1 311 7451
POINT, Contact (Delco Remy).....	59 01-10-20-80 (WOD).....	1 311 9648
BLADE, Contact (Delco Remy).....	59 01-10-20-80 (WOD).....	1 311 9662
SEAL, Pawl Operating Rod Oil.....	59 01-10-20-80 (WOD).....	1 312 3416
SCREW.....	59 01-10-20-80 (WOD).....	2 G180075
WASHER (Lock).....	59 01-10-20-80 (WOD).....	2 G114605

6.329 GOVERNOR, Overdrive

GOVERNOR.....	59 01-10-20 (WOD).....	1 311 2914
(11-39 Ratio).....	59 80 (WOD).....	1 315 7033
(10-41 Ratio).....	59 80 (WOD).....	1 311 2914
GEAR.....	59 01-10-20-80 (WOD).....	1 312 3670
Drive.....	59 01-10-20 (WOD).....	1 311 2157
	59 80 (WOD).....	1 315 0720
KEY, Drive Gear.....	59 01-10-20-80 (WOD).....	1 G106749
RING, Gear Retainer.....	59 01-10-20-80 (WOD).....	1 312 3674
BOOT.....	59 01-10-20-80 (WOD).....	1 313 1032
SCREW, Terminal.....	59 01-10-20-80 (WOD).....	1 G447119
WIRE, To Kickdown Switch.....	59 01-10-20-80 (WOD).....	1 314 7515
CLIP, Kickdown Switch Wire.....	59 01-10-20-80 (WOD).....	1 315 1713

6.330 CAM, Overdrive Free Wheeling

CAM.....	59 01-10-20 (WOD).....	1 312 3660
	59 80 (WOD).....	1 315 0704
CLIP, Retainer.....	59 01-10-20 (WOD).....	1 312 3661
To Pinion Cage Retainer.....	59 01-10-20 (WOD).....	1 312 3676
RING (.062).....	59 80 (WOD).....	1 315 0700
(.068).....	59 80 (WOD).....	1 315 0699
(.074).....	59 80 (WOD).....	1 315 0698

6.332 ROLLER, Overdrive Free Wheeling

ROLLER SET (Incl. 12 Rollers).....	59 01-10-20 (WOD).....	1 310 8236
	59 80 (WOD).....	1 320 0061
SPRING, Retainer.....	59 01-10-20-80 (WOD).....	2 91 237

6.336 SHAFT, Overdrive Main

SHAFT.....	59 01-10-20 (WOD).....	1 311 4002
	59 80 (WOD).....	1 315 0706
SLEEVE, Spacer.....	59 01-10-20 (WOD).....	1 311 4000
RING, Snap (.086).....	59 80 (WOD).....	1 315 0622
(.087).....	59 01-10-20 (WOD).....	1 310 8405
(.089).....	59 80 (WOD).....	1 315 0657
(.090).....	59 01-10-20 (WOD).....	1 310 8406
(.092).....	59 80 (WOD).....	1 315 0658
(.093).....	59 01-10-20 (WOD).....	1 310 8407
(.095).....	59 80 (WOD).....	1 315 0659
(.096).....	59 01-10-20 (WOD).....	1 310 8408

OVERDRIVE

6.338 SHAFT ASSEMBLY, Overdrive Control

SHAFT ASSEMBLY.....	59 01-10-20 (WOD).....	1	314 4612
	59 80 (WOD).....	1	315 0713
SEAL, Oil.....	59 01-10-20-80 (WOD).....	1	312 3668
PIN, Taper.....	59 01-10-20-80 (WOD).....	1	G103565
SPACER, Lever.....	59 80 (WOD).....	1	315 0721
BOLT.....	59 80 (WOD).....	1	315 0722
WASHER (Plain).....	59 80 (WOD).....	1	G103340
(Lock).....	59 80 (WOD).....	1	G114605
NUT.....	59 80 (WOD).....	1	G120368

6.350 CONTROL, Overdrive

CORE.....	59 01-10 (WOD).....	1	311 7470
	59 20 (WOD).....	1	320 0281
	59 80 (WOD).....	1	320 0774
ARMOR.....	59 01-10 (WOD).....	1	311 9134
	59 20 (WOD).....	1	320 0282
	59 80 (WOD).....	1	320 0775
BUSHING.....	59 10-20-80 (WOD).....	1	314 6956
CLIP, To Front Suspension Mounting Bracket.....	59 20 (WOD).....	1	47 272
NUT, Cable To Bracket.....	59 01-10-20-80 (WOD).....	1	G114499
WASHER (Lock), Cable To Bracket.....	59 01-10-20-80 (WOD).....	1	G115554

6.352 BUTTON, Overdrive Control

BUTTON.....	59 01-10-20-80 (WOD).....	1	320 0216
-------------	---------------------------	---	----------

6.357 BRACKET, Overdrive Control Shaft To Dash

BRACKET.....	59 01 (WOD).....	1	313 0969
	59 10-20-80 (WOD).....	1	313 1198
SCREW.....	59 10-20-80 (WOD).....	2	800 0093
NUT.....	59 10-20-80 (WOD).....	1	G120368
WASHER (Lock).....	59 10-20-80 (WOD).....	1	G120614
	59 10-20-80 (WOD).....	1	G131096

6.358 CLAMP, Overdrive Control Cable Lower

CLAMP.....	59 01-10-20-80 (WOD).....	1	530 6722
SCREW.....	59 01-10-20-80 (WOD).....	1	G180020
NUT.....	59 01-10-20-80 (WOD).....	1	G120375
WASHER (Lock).....	59 01-10-20-80 (WOD).....	1	G120380

6.363 TRUNNION, Overdrive Control

TRUNNION.....	59 01-10-20 (WOD).....	1	312 1626
	59 80 (WOD).....	1	315 1508
SCREW.....	59 01-10-20-80 (WOD).....	1	312 1627
NUT.....	59 01-10-20-80 (WOD).....	1	G120367
WASHER (Plain).....	59 01-10-20-80 (WOD).....	1	G120392
(Lock).....	59 01-10-20-80 (WOD).....	1	G120380

OVERDRIVE

6.365 RELAY, Overdrive Kickdown

RELAY.....	59 01-10-20-80 (WOD).....	1	315 6019
FUSE (15 AMP).....	59 01-10-20-80 (WOD).....	1	G120151
SCREW (Incl. Washer)(#12 - 11 x 1/2).....	59 01-10-20-80 (WOD).....	2	800 0105
(#14 - 10 x 5/8).....	59 01 (WOD).....	2	800 0103

6.367 SWITCH, Overdrive Kickdown

SWITCH.....	59 01 (WOD).....	1	313 8276
	59 10-20-80 (WOD).....	1	314 6726
RETAINER.....	59 01 (WOD).....	1	315 4600
SPRING.....	59 01 (WOD).....	1	315 4601
Retainer.....	59 01 (WOD).....	1	G451786
PELLET.....	59 01 (WOD).....	1	312 5873
WIRE, To Governor (20" Length)(Bullet And			
Eyelet Terminals).....	59 01-10-20-80 (WOD).....	1	314 7515
To Governor (8" Length)(2 Bullet			
Terminals).....	59 01-10-80 (WOD).....	1	315 7586
To Coil.....	59 01-20-80 (WOD).....	1	315 4314
CLIP.....	59 01-10-20-80 (WOD).....	1	315 1713
CONNECTOR, Wire.....	59 01-10-20-80 (WOD).....	1	312 7171
SCREW.....	59 01 (WOD).....	2	G445656
Pellet.....	59 01 (WOD).....	1	310 8350
WASHER (Lock).....	59 10-20-80 (WOD).....	1	G115550
(Plain).....	59 10-20-80 (WOD).....	1	800 0179
NUT.....	59 01 (WOD).....	2	312 6533
	59 10-20-80 (WOD).....	1	G272123

6.370 BRACKET, Overdrive Kickdown Switch

BRACKET.....	59 01 (WOD).....	1	313 6723
	59 10 (LHD-LDT-WOD).....	1	315 6274
	59 10 (LHD-WDT-WOD).....	1	315 4256
	59 20-80 (WOD).....	1	315 4269